

ELECTRICAL SCHEMATIC:

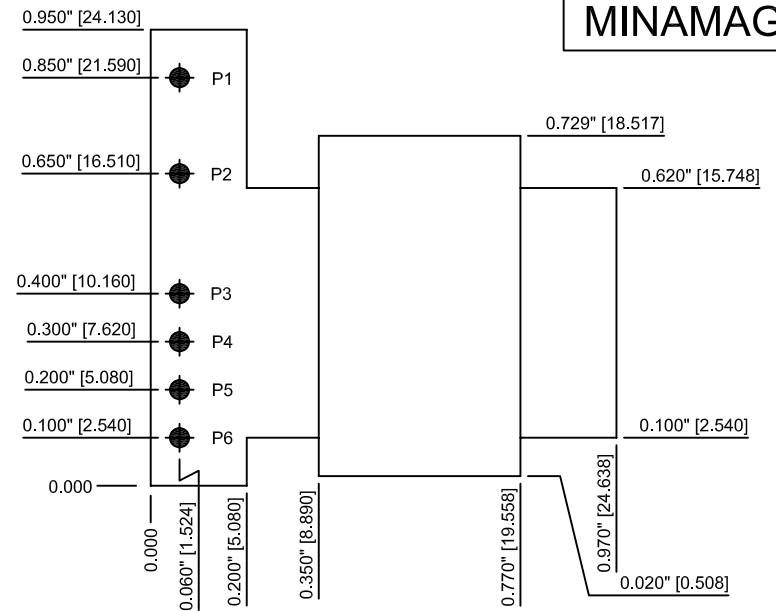
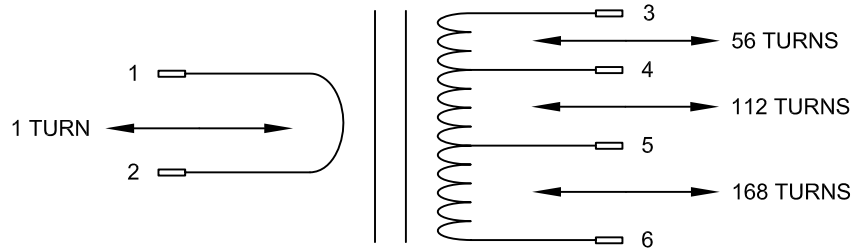

ELECTRICAL CHARACTERISTICS @ 25° C

Part no.	Secondary Induction ±25%	Turn Ratio Np:Ns ±1%	Primary DCR mOhm Max	Secondary DCR mOhm Max	Hipot (Pri-Sec) 60 Hz 2 SEC VRMS	Primary Current Amps Max
MMCSTA - 056	1.6 mH	1:56	0.50	15	3750	50
MMCSTA - 112	6.5 mH	1:112	0.45	29	3750	50
MMCSTA - 168	14.6 mH	1:168	0.40	45	3750	50

ELECTRICAL CHARACTERISTICS @ 25° C

Part no.	Secondary Induction ±25%	Turn Ratio Np:Ns ±1%	Primary DCR mOhm Max	Secondary DCR mOhm Max	Hipot (Pri-Sec) 60 Hz 2 SEC VRMS	Primary Current Amps Max
MMCSTB - 056	4.2 mH	1:56	0.50	15	3750	60
MMCSTB - 112	16.9 mH	1:112	0.45	29	3750	60
MMCSTB - 168	38.1 mH	1:168	0.40	45	3750	60

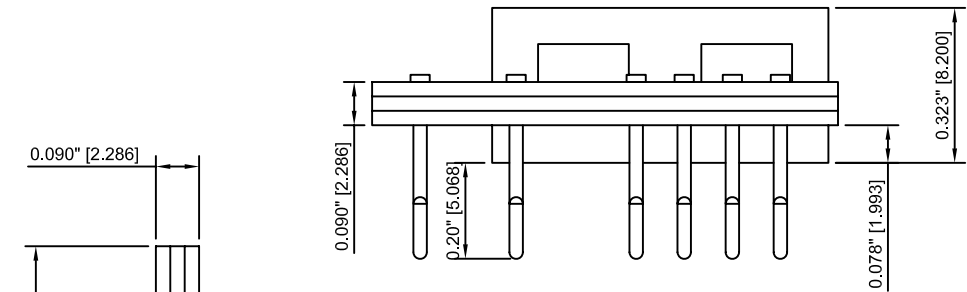

CURRENT SENSE TRANSFORMER E18-EW
THROUGH HOLE LAND PATTERN HORIZONTAL MOUNT

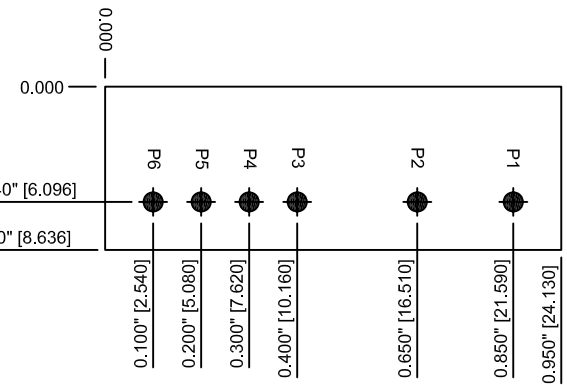
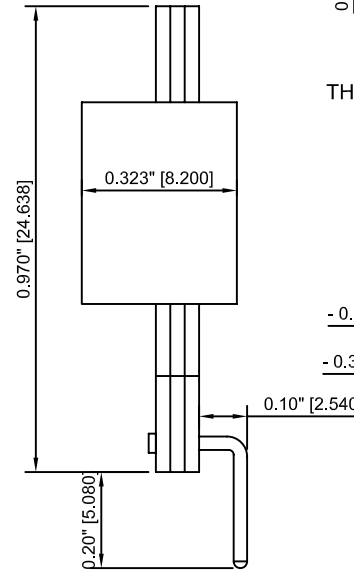

CURRENT SENSE TRANSFORMER E18-EW
THROUGH HOLE LAND PATTERN VERTICAL MOUNT

*** ROUND HOLES ARE 0.040" DIAMETER